

Courses up Allegheny River

- N. 4. E. 26
- N. 14. E. 28
- N. 18. E. 28
- N. 30. E. 44
- N. 35. E. 34
- N. 43. E. 56
- 216 perches

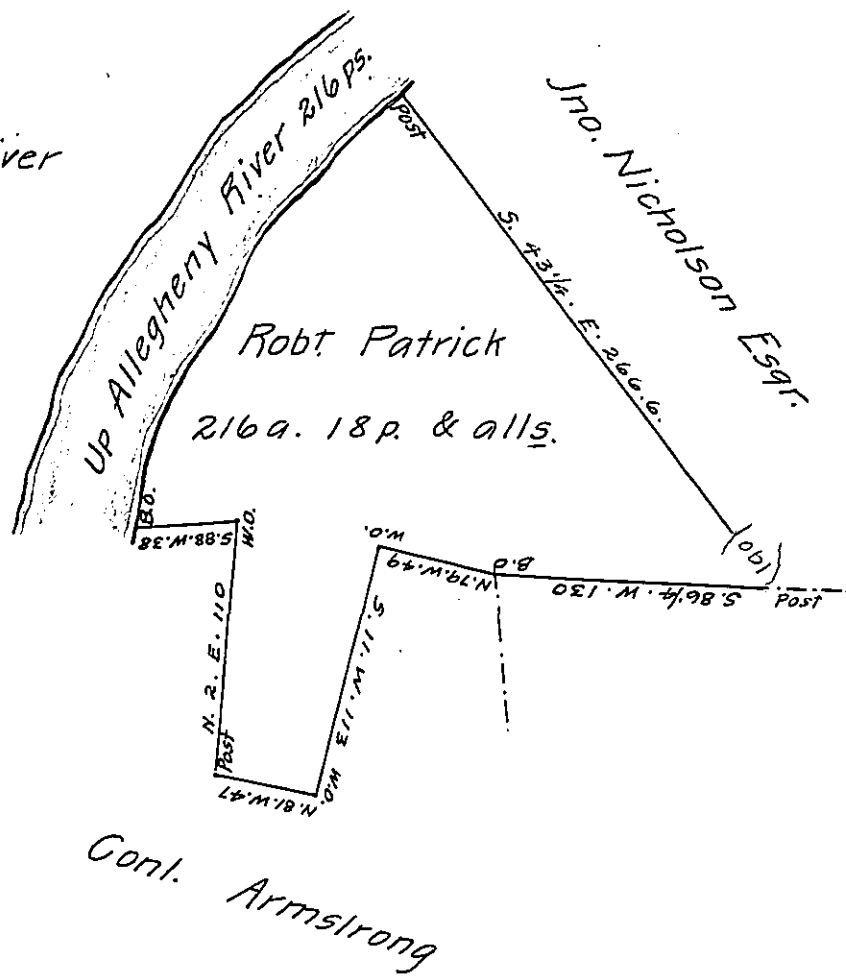

Surveyed to Robert Patrick on the 3rd. day of May 1804 the above described Tract of Land. Containing Two hundred and Sixteen acres and Eighteen perches and allowance of Six p.Cent &. Situate in Toby Township Armstrong County on the East side of Allegheny river By Warrant of 8th. December 1803 Numbered 5847.

Geo. Ross D.S.

To Saml. Cochran Esqr. S.G.

IN TESTIMONY that the above is a copy of the original remaining on file in the Department of Internal Affairs of Pennsylvania, made conformably to an Act of Assembly approved the 16th day of February, 1833, I have hereunto set my Hand and caused the Seal of said Department to be affixed at Harrisburg, this ninth day of July 1906

*Isaac P. Brown*  
Secretary of Internal Affairs.